



Morgans

PROPERTY

161b Townhill Road, Dunfermline, KY12 0DP

Offers Over £85,000







Charming upper traditional garden flat on Townhill Road. The property is well presented and generous throughout with the benefit of well maintained communal gardens. External storage/outhouse. The subjects are fresh throughout and briefly comprise fitted kitchen with appliances, lounge, spacious double bedroom, bathroom and utility cupboard. The property is double glazed with electric storage heaters and there is on street parking. Early entry available.

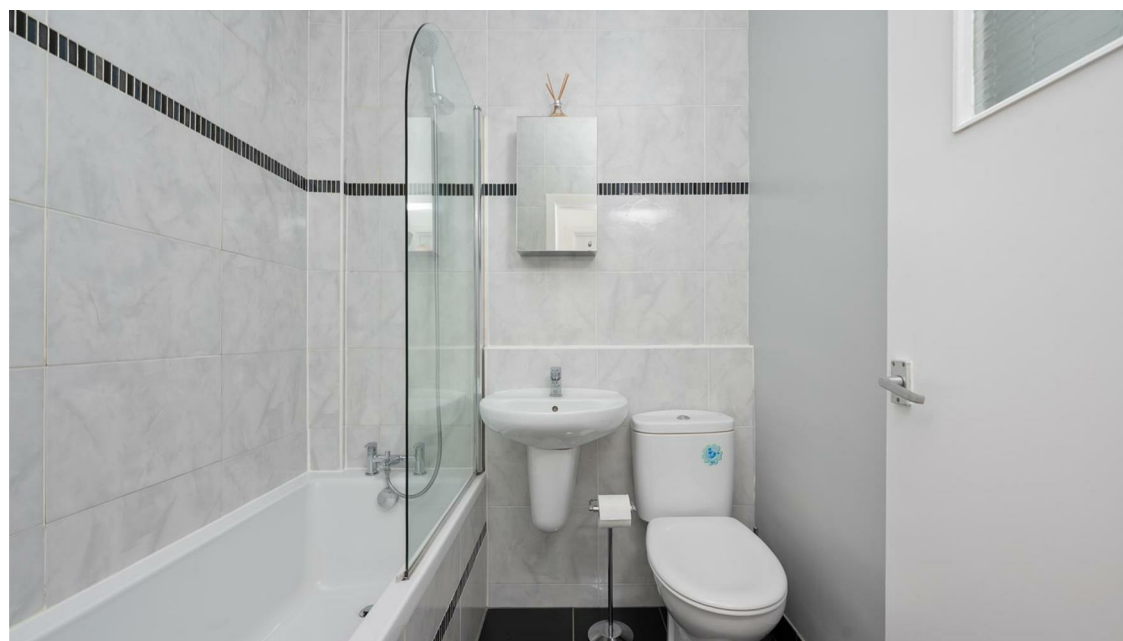



The ancient capital of Dunfermline won its bid to have official status city in May 2022, as part of the civic honour's competition to celebrate the Queen's platinum jubilee. The City of Dunfermline is of considerable historic interest and is the resting place of King Robert the Bruce. Carnegie's Birthplace museum, the Abbey and Abbot House reflect the historic interest of the city, whilst recent developments have seen Dunfermline move into the modern era with Carnegie Museum and Library. Dunfermline is located approximately five miles from the Forth bridges and is therefore particularly popular with commuters to Edinburgh and many parts of the central belt with easy access to the M90 motorway with its direct links to Edinburgh, Perth and Dundee and across the Kincardine Bridge by way of motorways to Stirling, Glasgow and the West. It benefits from a full range of shops, social and leisure facilities and educational establishments. The local railway stations provide a regular service to Edinburgh with intercity links to other parts of the UK. There are regular and convenient bus services both local and national.

All floor coverings, blinds, bathroom and light fittings together with integrated appliances.

A map of Dunfermline, Scotland, showing the location of a property marked with a red pin. The property is situated near the intersection of A823 and B912, close to the areas of Townhill and Wellwood. Other nearby locations include Headwell, Bellyeoman, Garvock, Touch, Woodmill Rd, and Abbeyview. The map also shows the Dunfermline Abbey and Palace and the St Leonards area. The map is sourced from Google Maps, with data from 2025.



161b Townhill Road, Dunfermline, KY12 0DP

Total Area: 49.0 m² ... 528 ft²

All measurements are approximate and for display purposes only

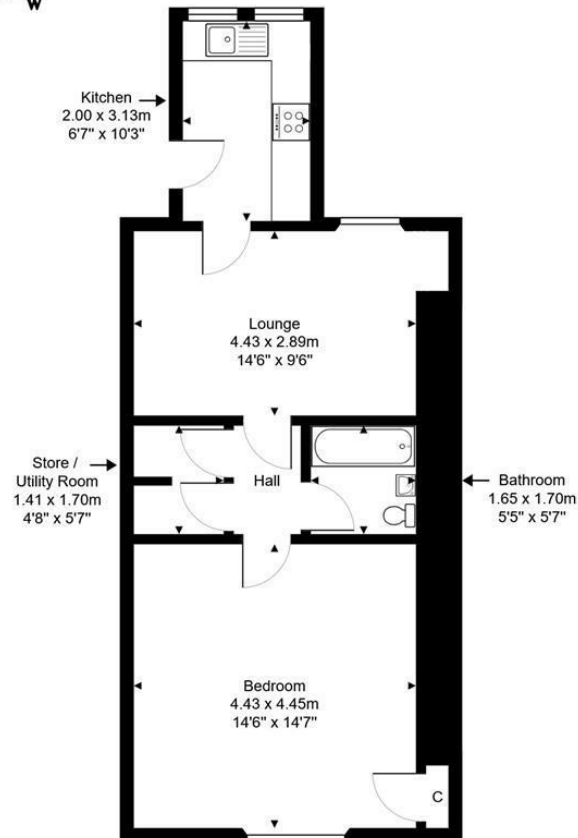

1st Floor



SOLICITORS | PROPERTY

33 East Port, Dunfermline, Fife, KY12 7JE

Tel: 01383 620222 Fax: 01383 621213

www.morganlaw.co.uk



AGENTS NOTE These particulars do not form part of any contract and the statements or plans contained herein are not warranted nor to scale. Approximate measurements have been taken by electronic device at the widest point. Services and appliances have not been tested for efficiency or safety and no warranty is given as to their compliance with any Regulations. No movable items will be included in the sale.